

 **Troll-master**
Contributing to your success

Peakhorse[®]

Downrigger System



**OWNER
MANUAL**



Dual Rod Holder

THANK YOU,

We hope you enjoy this product!

We at Troll-master thank you for purchasing our product! Seahorse® Adjustable Dual Rod Holder is designed to simplify the complexities and take logistics out of the equation. The attachment is designed to be securely clamped on the boom of the downrigger providing better utilization of cockpit space while keeping the fishing rods in a handy yet secure positions. Dual Axis Adjustment ability for both rod holder tubes enables anglers to set a perfect angle at any position independently of each other while trolling with multiple rods. This product is made out of corrosion resistant materials that ensure durability, long life and trouble free operation. It is optimized to work well with all light, medium and heavy rods, conventional or spinning outfits. In order to maximize compatibility this attachment is designed to fit majority of Cannon®, all Penn® and Seahorse® downrigger booms.

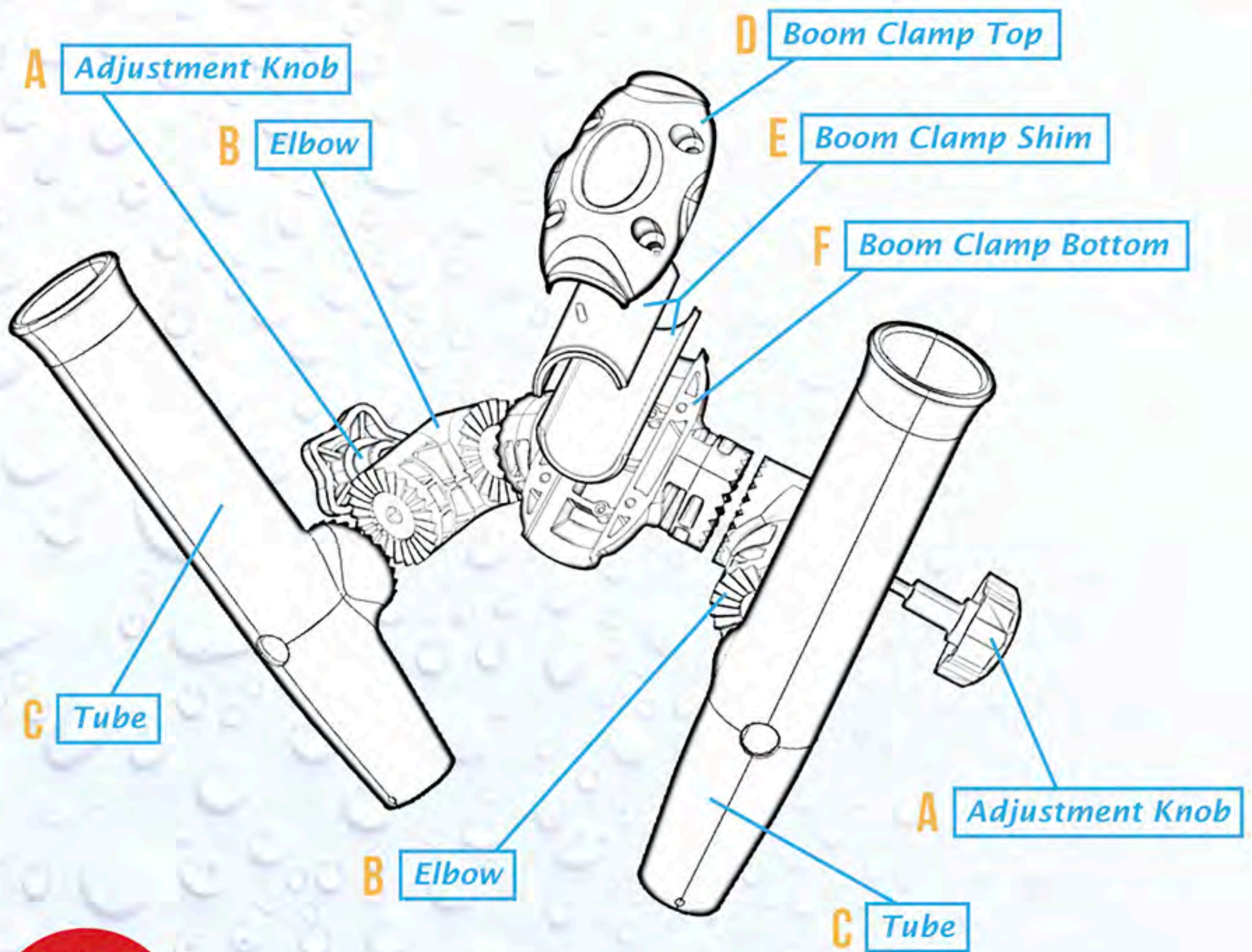

For more information, visit our website
www.Troll-master.com

PARTS INCLUDE:



A

(x2) Rod Holder
Adjustment Knob
DSP-S72123



B

(x2) Rod Holder
Elbow
DSP-S72122



C

(x2) Rod Holder
Tube
DSP-S72120



D

Boom Clamp
Top
DSP-S72125



E

Boom Clamp
Shim
DSP-S72124



F

Boom Clamp
Bottom
DSP-S72126

ASSEMBLY

- 1 Wrap one layer of electrical tape around your downrigger boom in the area where you would like to install the **Boom Clamp**. This will ensure the best grip for the clamp and will also protect the boom of the downrigger from possible scuffs or abrasions.
- 2 Separate the **Top and the Bottom parts of the Boom Clamp** held by four machine screws. Note: Cannon® downriggers have larger diameter booms. If you are installing this Rod holder attachment on the Cannon® downrigger, please remove the supplied **Shims** from the **Boom Clamp**.
- 3 Place the **lower Boom Clamp** under the boom and over previously tape wrapped area and cover with the **Upper Boom Clamp**. Securely tighten the four machine screws that are holding the Boom Clamp together. Please do not over torque the screws – this can cause damage to the downrigger boom or the Boom Clamp.
- 4 Use the small hole in the **Rod holder tube** to access the adjustment screw to set the desired angle for the Right rod holder tube horizontally. Use the **Adjustment Knob** to set the desired angle for the Right Rod holder tube vertically. Please repeat these adjustments for the Left Rod holder tube¹.

 **Troll-master**
Contributing to your success

 **Leahorse**®
Downrigger System

*Improving your
fishing experience!*



MISSION

Troll-master Inc. is committed to the development and manufacturing of the high quality parts and accessories for the fishing industry. Our goal is to deliver a good product at a competitive price while maintaining the highest quality standards.

TEAM

Troll-master's team consists of professional engineers, tournament winning captains, fishing enthusiasts and manufacturing experts. Our R&D works in conjunction with real customers across the country utilizing hands on experience and cutting edge technology to design our products.

PRODUCTS

All our products come with a 10 year manufacturer's warranty. There is no fine print, no exclusions and no limitations. We will always stand behind our products and will gladly provide Customer Service and Technical Support to our customers. We are confident in the quality of the products, functional design and the materials used to produce them.

WARRANTY

Troll-master Inc. warrants to the original purchaser any defect in material or workmanship for the period of 10 years since the date of the original retail purchase. Troll-master Inc. will either repair or replace the product free of charge.

